



VISION SERIES PANELS

All the strength and security you have come to expect from VSA, in a new lightweight format.

Vision Series Lightweight

Class M - 90mm Thick 90kg. per sq.m
*Std. Panel Width 750mm

Class I - 140mm Thick 115kg per sq.m
*Std. Panel Width 750mm

Class II - 267mm Thick 200kg. per sq.m
*Std. Panel Width 750mm

Class III - 305mm Thick 340kg. per sq.m
*Std. Panel Width 750mm

When weight is a major concern...

VSA has the Vision to maximize your vault security.

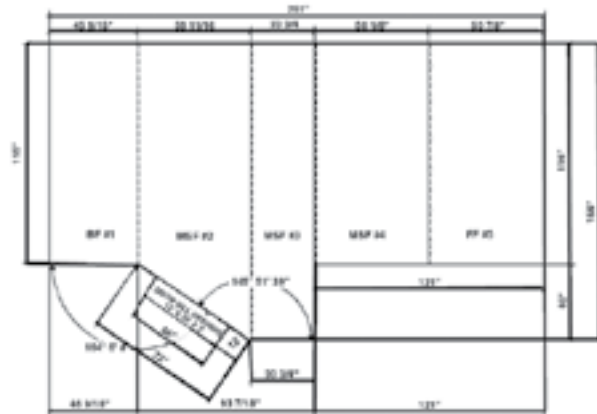

*Smaller panel widths available at additional cost, consult sales for details.

VSA - BE A PART OF OUR VISION

The lightweight modular vault weighs less than half of a modular concrete vault, allowing the vault to be placed anywhere, and carries the same Underwriters Laboratory rating as concrete panels. The pressurized laminate is enclosed in corrosion resistant galvanized steel.

The panels are sized to meet the specific job requirement. The vault ceiling panels span up to 10m and may be installed either across the width or depth of the vault. For spans exceeding 4.2m, an I-Beam is required.

Coordinated with your architects, designers and engineers throughout the fabrication process. Delivery and installation by our experienced teams to provide a total solution.

VSA's Vision series panels are ideal for vaults on a second story or for vaults with a basement



Manufacturer reserves the right to change product specifications without notice.